

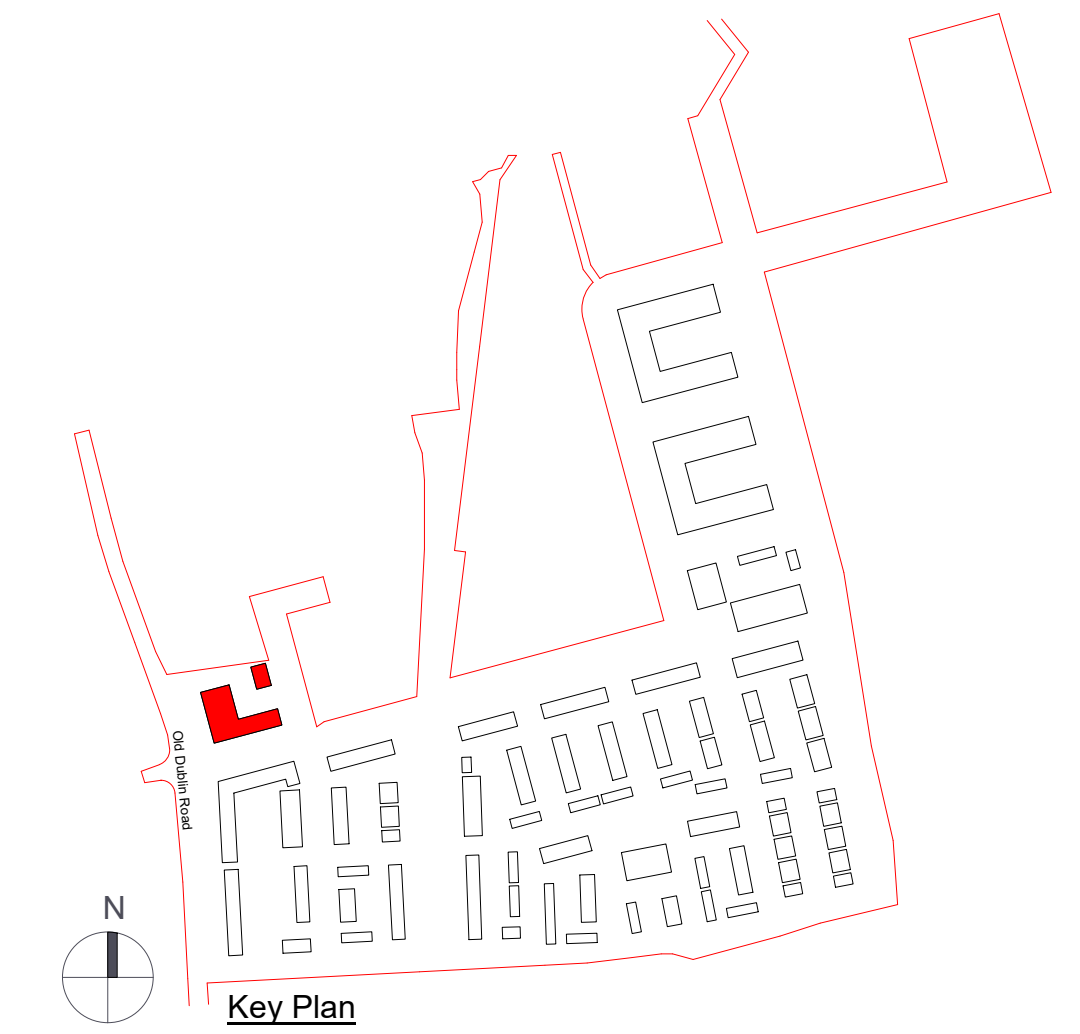

2 BD-East Elevation 1:200



3 BD-West Elevation 1:200



Key Plan

- 1 Brick Type A
- 2 Brick Type B
- 3 Brick Type C
- 4 Pre-Cast Frame Type A
- 5 Pre-Cast Frame Type B
- 6 Selected Render
- 7 Selected Contrasting Render
- 8 Metal Balustrade
- 9 Double Glazed Window System with Spandrel Panel
- 10 Selected Sedum Roof
- 11 Selected Metal Ventilation Grille



4 BD-Courtyard East Section/Elevation 1:200



5 BD-Courtyard North Section/Elevation 1:200



1 BD-South Elevation 1:200



6 BD-North Elevation 1:200

All levels (in meters) are related to Malin head datum.  
All dimensions in millimeters.  
Figured dimensions only are to be taken from this drawing.

Revision Description	Date	Rev. No.	Issued by
Issued for Planning	09.10.2019	1	TT

Figured dimensions only to be used. This drawing is copyright of O'Mahony Pike Architects Ltd. All information is shared as per approved use in accordance with BS1192(2007) + A2(2016), Table 5; Standard Codes for Suitability of Models and Documents. If the 'Status' field is empty, this information has been shared at 50 - WIP.

**omahony pike** Project No.: 1618 Scale@ A1: 1 : 200

architecture | urban design Project Lead: SD Date Printed: 09.10.2019

email: info@omahonypike.com Dublin 26 South Mall

tel: +353 1 202 7400 The Chapel Mount St. Anne's

fax: +353 1 283 0822 Cork City Cork City

www.omahonypike.com Milltown, Dublin 6 Co. Cork

D06 XN52 Ireland T12 R2RV Ireland

Drawn By: TT Model No.: 1618-OMP-00-M3-A-0001

Purpose: Planning Current Rev.: 1 Status: S0

Project: Woodbrook Phase 1  
Location: Woodbrook  
Client: Aeval

Drawing Title: Block D - Elevations and Sections  
Drawing No.: 1618-OMP-BD-ZZ-DR-A-21001